

## Shoulder screws similar to DIN ISO 7379

### Item description/product images



### Description

#### Material:

Steel or stainless steel (A 2)

#### Version:

Grade 12.9. Shaft OD ground and bright.  
Bright stainless steel or tempered steel.

#### Note:

Hexagon socket head shoulder screws are precision construction elements for many applications. As they can simplify complicated constructions, they are frequently chosen as the most cost-effective solution. Shoulder screws provide the decisive rationalising effect required today.

### Drawings

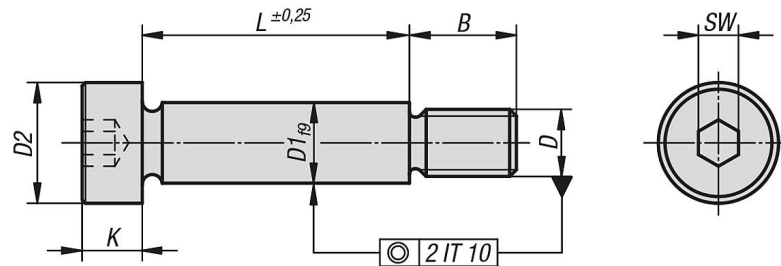

### Overview of items

#### Shoulder screws similar to DIN ISO 7379

Order No.	Main material	D1	D	D2	B	K	SW	L
K0705.04X06	steel	4	M3	7	7	3	2	6
K0705.04X08	steel	4	M3	7	7	3	2	8
K0705.04X10	steel	4	M3	7	7	3	2	10
K0705.04X12	steel	4	M3	7	7	3	2	12
K0705.04X16	steel	4	M3	7	7	3	2	16
K0705.04X20	steel	4	M3	7	7	3	2	20
K0705.05X08	steel	5	M4	9	8	4	2,5	8
K0705.05X10	steel	5	M4	9	8	4	2,5	10
K0705.05X16	steel	5	M4	9	8	4	2,5	16
K0705.05X20	steel	5	M4	9	8	4	2,5	20
K0705.05X30	steel	5	M4	9	8	4	2,5	30
K0705.05X40	steel	5	M4	9	8	4	2,5	40
K0705.06X16	steel	6	M5	10	9,5	4,5	3	16
K0705.06X20	steel	6	M5	10	9,5	4,5	3	20
K0705.06X25	steel	6	M5	10	9,5	4,5	3	25
K0705.06X30	steel	6	M5	10	9,5	4,5	3	30
K0705.06X40	steel	6	M5	10	9,5	4,5	3	40
K0705.06X50	steel	6	M5	10	9,5	4,5	3	50
K0705.06X60	steel	6	M5	10	9,5	4,5	3	60
K0705.08X16	steel	8	M6	13	11	5,5	4	16
K0705.08X20	steel	8	M6	13	11	5,5	4	20
K0705.08X25	steel	8	M6	13	11	5,5	4	25
K0705.08X30	steel	8	M6	13	11	5,5	4	30

## Shoulder screws similar to DIN ISO 7379

## Overview of items

Order No.	Main material	D1	D	D2	B	K	SW	L
K0705.08X40	steel	8	M6	13	11	5,5	4	40
K0705.08X50	steel	8	M6	13	11	5,5	4	50
K0705.08X60	steel	8	M6	13	11	5,5	4	60
K0705.10X16	steel	10	M8	16	13	7	5	16
K0705.10X20	steel	10	M8	16	13	7	5	20
K0705.10X25	steel	10	M8	16	13	7	5	25
K0705.10X30	steel	10	M8	16	13	7	5	30
K0705.10X40	steel	10	M8	16	13	7	5	40
K0705.10X50	steel	10	M8	16	13	7	5	50
K0705.10X60	steel	10	M8	16	13	7	5	60
K0705.10X70	steel	10	M8	16	13	7	5	70
K0705.10X80	steel	10	M8	16	13	7	5	80
K0705.12X16	steel	12	M10	18	16	9	6	16
K0705.12X20	steel	12	M10	18	16	9	6	20
K0705.12X25	steel	12	M10	18	16	9	6	25
K0705.12X30	steel	12	M10	18	16	9	6	30
K0705.12X40	steel	12	M10	18	16	9	6	40
K0705.12X50	steel	12	M10	18	16	9	6	50
K0705.12X60	steel	12	M10	18	16	9	6	60
K0705.12X70	steel	12	M10	18	16	9	6	70
K0705.12X80	steel	12	M10	18	16	9	6	80
K0705.12X90	steel	12	M10	18	16	9	6	90
K0705.12X100	steel	12	M10	18	16	9	6	100
K0705.16X30	steel	16	M12	24	18	11	8	30
K0705.16X40	steel	16	M12	24	18	11	8	40
K0705.16X50	steel	16	M12	24	18	11	8	50
K0705.16X60	steel	16	M12	24	18	11	8	60
K0705.16X70	steel	16	M12	24	18	11	8	70
K0705.16X80	steel	16	M12	24	18	11	8	80
K0705.16X90	steel	16	M12	24	18	11	8	90
K0705.16X100	steel	16	M12	24	18	11	8	100
K0705.16X120	steel	16	M12	24	18	11	8	120
K0705.20X30	steel	20	M16	30	22	14	10	30
K0705.20X40	steel	20	M16	30	22	14	10	40
K0705.20X50	steel	20	M16	30	22	14	10	50
K0705.20X60	steel	20	M16	30	22	14	10	60
K0705.20X70	steel	20	M16	30	22	14	10	70
K0705.20X80	steel	20	M16	30	22	14	10	80
K0705.20X90	steel	20	M16	30	22	14	10	90
K0705.20X100	steel	20	M16	30	22	14	10	100
K0705.20X120	steel	20	M16	30	22	14	10	120
K0705.104X06	stainless steel	4	M3	7	7	3	2	6
K0705.104X08	stainless steel	4	M3	7	7	3	2	8
K0705.104X10	stainless steel	4	M3	7	7	3	2	10
K0705.104X16	stainless steel	4	M3	7	7	3	2	16
K0705.104X20	stainless steel	4	M3	7	7	3	2	20
K0705.105X08	stainless steel	5	M4	9	8	4	2,5	8
K0705.105X10	stainless steel	5	M4	9	8	4	2,5	10
K0705.105X16	stainless steel	5	M4	9	8	4	2,5	16
K0705.105X20	stainless steel	5	M4	9	8	4	2,5	20
K0705.105X30	stainless steel	5	M4	9	8	4	2,5	30
K0705.105X40	stainless steel	5	M4	9	8	4	2,5	40
K0705.106X16	stainless steel	6	M5	10	9,5	4,5	3	16
K0705.106X20	stainless steel	6	M5	10	9,5	4,5	3	20
K0705.106X25	stainless steel	6	M5	10	9,5	4,5	3	25
K0705.106X30	stainless steel	6	M5	10	9,5	4,5	3	30
K0705.106X40	stainless steel	6	M5	10	9,5	4,5	3	40
K0705.106X50	stainless steel	6	M5	10	9,5	4,5	3	50
K0705.106X60	stainless steel	6	M5	10	9,5	4,5	3	60
K0705.108X16	stainless steel	8	M6	13	11	5,5	4	16
K0705.108X20	stainless steel	8	M6	13	11	5,5	4	20
K0705.108X25	stainless steel	8	M6	13	11	5,5	4	25

## Shoulder screws similar to DIN ISO 7379

### Overview of items

Order No.	Main material	D1	D	D2	B	K	SW	L
K0705.108X30	stainless steel	8	M6	13	11	5,5	4	30
K0705.108X40	stainless steel	8	M6	13	11	5,5	4	40
K0705.108X50	stainless steel	8	M6	13	11	5,5	4	50
K0705.108X60	stainless steel	8	M6	13	11	5,5	4	60
K0705.110X16	stainless steel	10	M8	16	13	7	5	16
K0705.110X20	stainless steel	10	M8	16	13	7	5	20
K0705.110X25	stainless steel	10	M8	16	13	7	5	25
K0705.110X30	stainless steel	10	M8	16	13	7	5	30
K0705.110X40	stainless steel	10	M8	16	13	7	5	40
K0705.110X50	stainless steel	10	M8	16	13	7	5	50
K0705.110X60	stainless steel	10	M8	16	13	7	5	60
K0705.110X70	stainless steel	10	M8	16	13	7	5	70
K0705.110X80	stainless steel	10	M8	16	13	7	5	80
K0705.112X16	stainless steel	12	M10	18	16	9	6	16
K0705.112X20	stainless steel	12	M10	18	16	9	6	20
K0705.112X25	stainless steel	12	M10	18	16	9	6	25
K0705.112X30	stainless steel	12	M10	18	16	9	6	30
K0705.112X40	stainless steel	12	M10	18	16	9	6	40
K0705.112X50	stainless steel	12	M10	18	16	9	6	50
K0705.112X60	stainless steel	12	M10	18	16	9	6	60
K0705.112X70	stainless steel	12	M10	18	16	9	6	70
K0705.112X80	stainless steel	12	M10	18	16	9	6	80
K0705.112X90	stainless steel	12	M10	18	16	9	6	90
K0705.112X100	stainless steel	12	M10	18	16	9	6	100
K0705.116X30	stainless steel	16	M12	24	18	11	8	30
K0705.116X40	stainless steel	16	M12	24	18	11	8	40
K0705.116X50	stainless steel	16	M12	24	18	11	8	50
K0705.116X60	stainless steel	16	M12	24	18	11	8	60
K0705.116X70	stainless steel	16	M12	24	18	11	8	70
K0705.116X80	stainless steel	16	M12	24	18	11	8	80
K0705.116X90	stainless steel	16	M12	24	18	11	8	90
K0705.116X100	stainless steel	16	M12	24	18	11	8	100
K0705.116X120	stainless steel	16	M12	24	18	11	8	120
K0705.120X30	stainless steel	20	M16	30	22	14	10	30
K0705.120X40	stainless steel	20	M16	30	22	14	10	40
K0705.120X50	stainless steel	20	M16	30	22	14	10	50
K0705.120X60	stainless steel	20	M16	30	22	14	10	60
K0705.120X70	stainless steel	20	M16	30	22	14	10	70
K0705.120X80	stainless steel	20	M16	30	22	14	10	80
K0705.120X90	stainless steel	20	M16	30	22	14	10	90
K0705.120X100	stainless steel	20	M16	30	22	14	10	100
K0705.120X120	stainless steel	20	M16	30	22	14	10	120

### Information about this article

KIPP shoulder screws are universally applicable. As a construction element they are suitable for a wide range of tasks in machine construction. If, for example, the position of workpieces is to be secured relative to one another, the use of shoulder screws is ideal. In contrast with conventional screws, shoulder screws have a limited play because the diameter of the screw shoulder and the hole are almost identical. This has the advantage that the screw connection is secure and the screw cannot slide back and forth. Shoulder screws count among the most secure and durable screw connections. The most common type in machine construction is shoulder screws with hexagon sockets. The product range from KIPP offers a range of shoulder screw types. In addition to the »hex head shoulder screws with long screw shank, there are also »shoulder screws similar to ISO 7379 and shoulder screws for the »5-axis UNI lock module system. To fasten the workpiece into position, the shoulder screw is screwed directly into the workpiece and then joined to the basic modules.