

## Indexing plungers

### Item description/product images

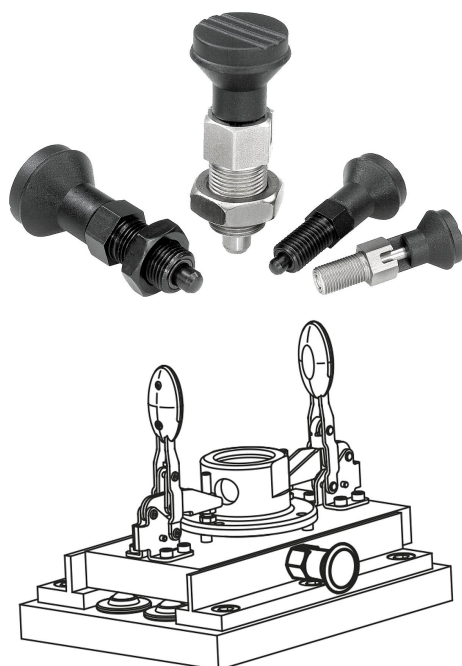

### Description

#### Material:

Steel version:  
Indexing pin hardened:  
grade 5.8.

Stainless steel version,  
Indexing pin hardened  
Threaded sleeve 1.4305  
Indexing pin 1.4034

Indexing pin not hardened  
Threaded sleeve 1.4305  
Indexing pin 1.4305

Mushroom knob black grey thermoplastic

#### Version:

Steel version:  
Indexing pin hardened, ground, black oxidised.

Stainless steel version:  
Indexing pin hardened, ground and bright.  
Indexing pin not hardened, ground and bright.

#### Note:

Indexing plungers are used to prevent any change in locking position due to lateral forces. A new locking position can only be set after the pin has been manually disengaged. Form C or D is recommended for applications in which the pin is disengaged over extended periods and should be prevented from springing back.

#### On request:

Special versions.

# Indexing plungers

## Drawings

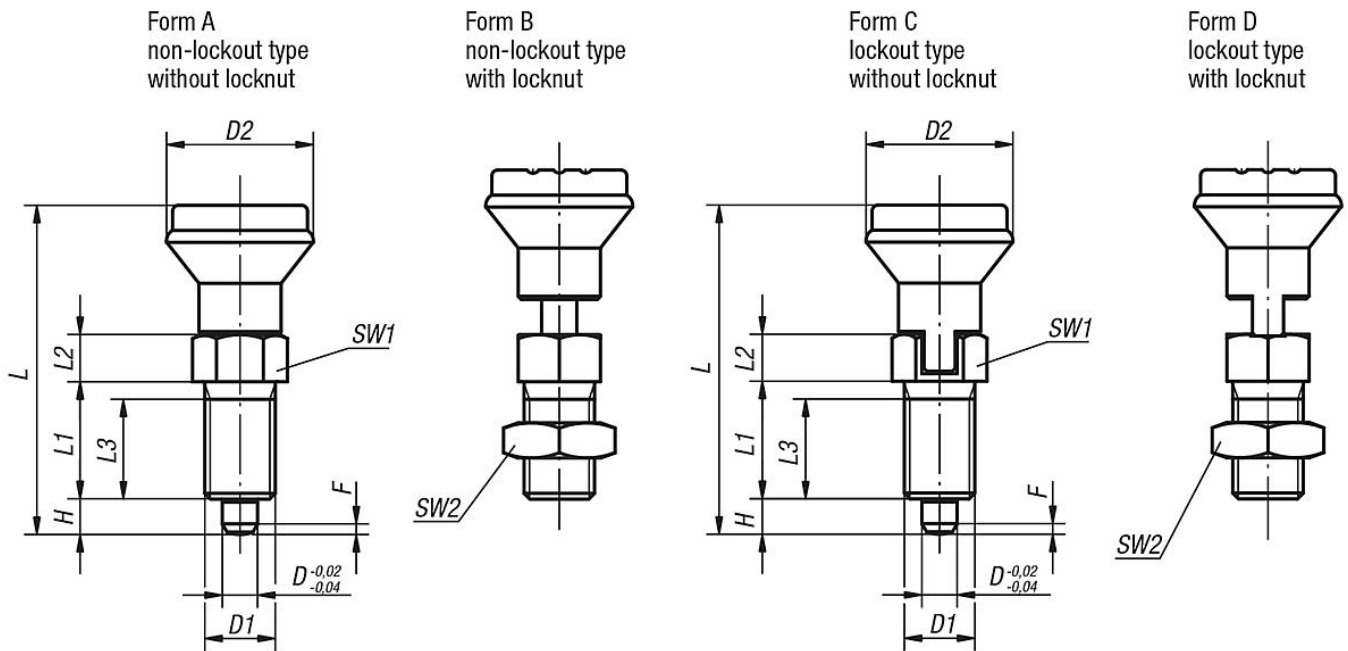

## Overview of items

### Indexing plungers, steel, indexing pin hardened

| Order No. Form A | Order No. Form B | Order No. Form C | Order No. Form D | D  | D1      | D2 | L  | L1 | L2 | L3 | H  | SW1 | SW2      | F x 30° | Spring force initial pressure F1 approx. N | Spring force final pressure F2 approx. N |
|------------------|------------------|------------------|------------------|----|---------|----|----|----|----|----|----|-----|----------|---------|--------------------------------------------|------------------------------------------|
| K0339.1105       | K0339.2105       | K0339.3105       | K0339.4105       | 5  | M10x1   | 21 | 47 | 17 | 7  | 15 | 5  | 13  | -/17-/17 | 1,3     | 5                                          | 12                                       |
| K0339.1206       | K0339.2206       | K0339.3206       | K0339.4206       | 6  | M12x1,5 | 25 | 56 | 20 | 8  | 17 | 6  | 14  | -/19-/19 | 1,8     | 6                                          | 14                                       |
| K0339.1308       | K0339.2308       | K0339.3308       | K0339.4308       | 8  | M16x1,5 | 33 | 74 | 26 | 10 | 23 | 8  | 19  | -/24-/24 | 2,3     | 15                                         | 35                                       |
| K0339.1410       | K0339.2410       | K0339.3410       | K0339.4410       | 10 | M20x1,5 | 33 | 80 | 28 | 12 | 25 | 10 | 22  | -/30-/30 | 2,8     | 15                                         | 34                                       |

### Indexing plungers, stainless steel, indexing pin hardened

| Order No. Form A | Order No. Form B | Order No. Form C | Order No. Form D | D  | D1      | D2 | L  | L1 | L2 | L3 | H  | SW1 | SW2      | F x 30° | Spring force initial pressure F1 approx. N | Spring force final pressure F2 approx. N |
|------------------|------------------|------------------|------------------|----|---------|----|----|----|----|----|----|-----|----------|---------|--------------------------------------------|------------------------------------------|
| K0339.01105      | K0339.02105      | K0339.03105      | K0339.04105      | 5  | M10x1   | 21 | 47 | 17 | 7  | 15 | 5  | 13  | -/17-/17 | 1,3     | 5                                          | 12                                       |
| K0339.01206      | K0339.02206      | K0339.03206      | K0339.04206      | 6  | M12x1,5 | 25 | 56 | 20 | 8  | 17 | 6  | 14  | -/19-/19 | 1,8     | 6                                          | 14                                       |
| K0339.01308      | K0339.02308      | K0339.03308      | K0339.04308      | 8  | M16x1,5 | 33 | 74 | 26 | 10 | 23 | 8  | 19  | -/24-/24 | 2,3     | 15                                         | 35                                       |
| K0339.01410      | K0339.02410      | K0339.03410      | K0339.04410      | 10 | M20x1,5 | 33 | 80 | 28 | 12 | 25 | 10 | 22  | -/30-/30 | 2,8     | 15                                         | 34                                       |

### Indexing plungers, stainless steel, indexing pin not hardened

| Order No. Form A | Order No. Form B | Order No. Form C | Order No. Form D | D  | D1      | D2 | L  | L1 | L2 | L3 | H  | SW1 | SW2      | F x 30° | Spring force initial pressure F1 approx. N | Spring force final pressure F2 approx. N |
|------------------|------------------|------------------|------------------|----|---------|----|----|----|----|----|----|-----|----------|---------|--------------------------------------------|------------------------------------------|
| K0339.11105      | K0339.12105      | K0339.13105      | K0339.14105      | 5  | M10x1   | 21 | 47 | 17 | 7  | 15 | 5  | 13  | -/17-/17 | 1,3     | 5                                          | 12                                       |
| K0339.11206      | K0339.12206      | K0339.13206      | K0339.14206      | 6  | M12x1,5 | 25 | 56 | 20 | 8  | 17 | 6  | 14  | -/19-/19 | 1,8     | 6                                          | 14                                       |
| K0339.11308      | K0339.12308      | K0339.13308      | K0339.14308      | 8  | M16x1,5 | 33 | 74 | 26 | 10 | 23 | 8  | 19  | -/24-/24 | 2,3     | 15                                         | 35                                       |
| K0339.11410      | K0339.12410      | K0339.13410      | K0339.14410      | 10 | M20x1,5 | 33 | 80 | 28 | 12 | 25 | 10 | 22  | -/30-/30 | 2,8     | 15                                         | 34                                       |